

Top Loading Wall Mounted Acrylic Sign Holder

Installation Instructions

1

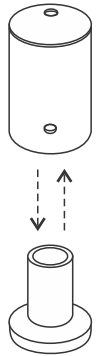

Separate each standoff from the base.

2

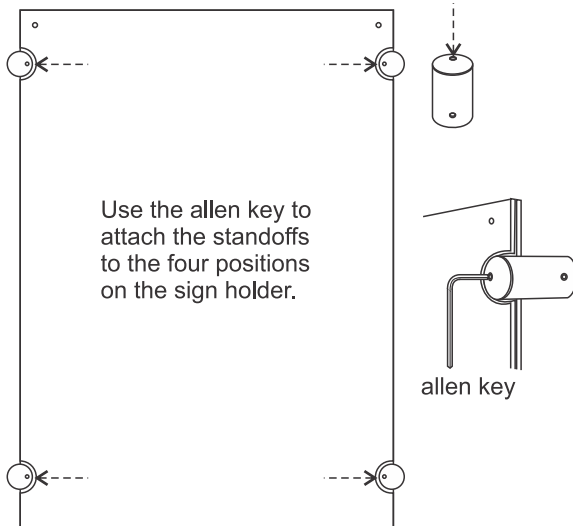

Use the allen key to attach the standoffs to the four positions on the sign holder.

allen key

3

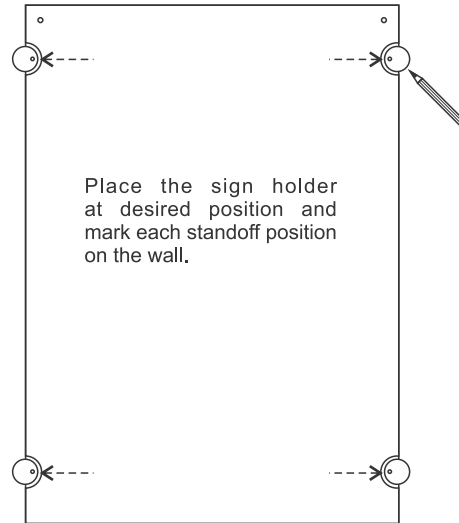

Place the sign holder at desired position and mark each standoff position on the wall.

4

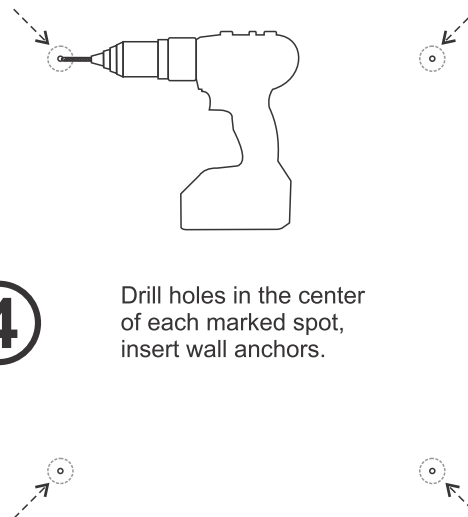

Drill holes in the center of each marked spot, insert wall anchors.

5

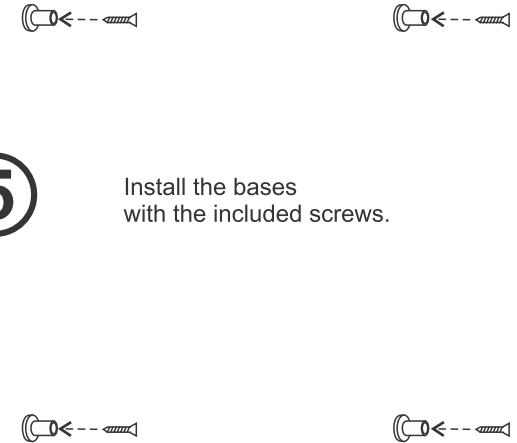

Install the bases with the included screws.

6

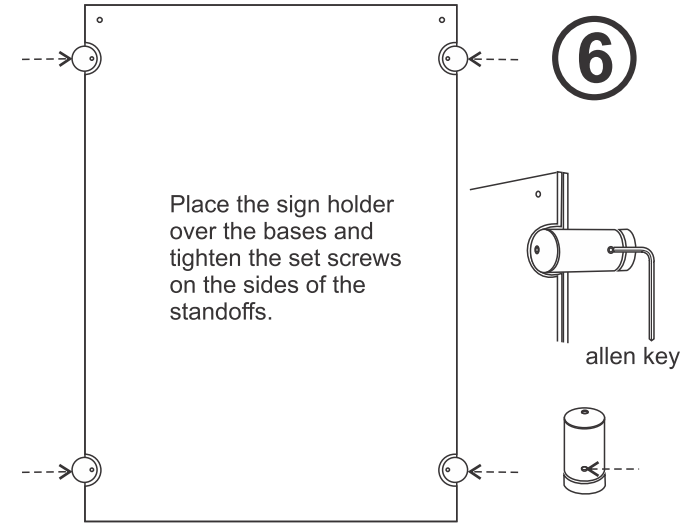

Place the sign holder over the bases and tighten the set screws on the sides of the standoffs.

allen key